

MINNESOTA

NORMAN

Form: FSA-156EZ

See Page 2 for non-discriminatory Statements.

United States Department of Agriculture  
Farm Service Agency

## Abbreviated 156 Farm Record

FARM : 2642

Prepared : 6/5/24 2:21 PM CST

Crop Year : 2024

Operator Name : JEANETTE H ANDERSON

CRP Contract Number(s) : None

Recon ID : None

Transferred From : None

ARCPLC G//F Eligibility : Eligible

## Farm Land Data

Farmland	Cropland	DCP Cropland	WBP	EWP	WRP	GRP	Sugarcane	Farm Status	Number Of Tracts
156.02	146.00	146.00	0.00	0.00	0.00	0.00	0.0	Active	1
State Conservation	Other Conservation	Effective DCP Cropland		Double Cropped		CRP	MPL	DCP Ag.Rel. Activity	SOD
0.00	0.00	146.00		0.00		0.00	0.00	0.00	0.00

## Crop Election Choice

ARC Individual	ARC County	Price Loss Coverage
None	WHEAT, CORN, BARLY	None

## DCP Crop Data

Crop Name	Base Acres	CCC-505 CRP Reduction Acres	PLC Yield	HIP
Wheat	30.10	0.00	37	
Corn	9.10	0.00	62	
Barley	33.70	0.00	65	
<b>TOTAL</b>	<b>72.90</b>	<b>0.00</b>		

## NOTES

Tract Number : 3742

Description : NE4-23 ST

FSA Physical Location : MINNESOTA/NORMAN

ANSI Physical Location : MINNESOTA/NORMAN

BIA Unit Range Number :

HEL Status : HEL field on tract.Conservation system being actively applied

Wetland Status : Tract contains a wetland or farmed wetland

WL Violations : None

Owners : SCOTT THOMAS BRING, JEANETTE H ANDERSON, MICHELE ALANE SHEA, T &amp; J FAMILY TRUST

Other Producers : None

Recon ID : None

## Tract Land Data

Farm Land	Cropland	DCP Cropland	WBP	EWP	WRP	GRP	Sugarcane
156.02	146.00	146.00	0.00	0.00	0.00	0.00	0.0

MINNESOTA

NORMAN

Form: FSA-156EZ

United States Department of Agriculture  
Farm Service Agency

## Abbreviated 156 Farm Record

FARM : 2642

Prepared : 6/5/24 2:21 PM CST

Crop Year : 2024

## Tract 3742 Continued ...

State Conservation	Other Conservation	Effective DCP Cropland	Double Cropped	CRP	MPL	DCP Ag. Rel Activity	SOD
0.00	0.00	146.00	0.00	0.00	0.00	0.00	0.00

## DCP Crop Data

Crop Name	Base Acres	CCC-505 CRP Reduction Acres	PLC Yield
Wheat	30.10	0.00	37
Corn	9.10	0.00	62
Barley	33.70	0.00	65
<b>TOTAL</b>	<b>72.90</b>	<b>0.00</b>	

## NOTES

In accordance with Federal civil rights law and U.S. Department of Agriculture (USDA) civil rights regulations and policies, the USDA, its Agencies, offices, and employees, and institutions participating in or administering USDA programs are prohibited from discriminating based on race, color, national origin, religion, sex, gender identity (including gender expression), sexual orientation, disability, age, marital status, family/parental status, income derived from a public assistance program, political beliefs, or reprisal or retaliation for prior civil rights activity, in any program or activity conducted or funded by USDA (not all bases apply to all programs). Remedies and complaint filing deadlines vary by program or incident.

Persons with disabilities who require alternative means of communication for program information (e.g., Braille, large print, audiotape, American Sign Language, etc.) should contact the responsible Agency or USDA's TARGET Center at (202) 720-2600 (voice and TTY) or contact USDA through the Federal Relay Service at (800) 877-8339. Additionally, program information may be made available in languages other than English.

To file a program discrimination complaint, complete the USDA Program Discrimination Complaint Form, AD-3027, found online at [http://www.ascr.usda.gov/complaint\\_filing\\_cust.html](http://www.ascr.usda.gov/complaint_filing_cust.html) and at any USDA office or write a letter addressed to USDA and provide in the letter all of the information requested in the form. To request a copy of the complaint form, call (866) 632-9992. Submit your completed form or letter to USDA by: (1) mail: U.S. Department of Agriculture, Office of the Assistant Secretary for Civil Rights, 1400 Independence Avenue, SW, Washington, D.C. 20250-9410; (2) fax: (202) 690-7442; or (3) e-mail: [program.intake@usda.gov](mailto:program.intake@usda.gov). USDA is an equal opportunity provider, employer, and lender.

## Norman County, Minnesota

**Farm 2642**

**Tract 3742**

**2024 Program Year**

Map Created June 05, 2024

**1454423**



Unless otherwise noted:

Shares are 100% operator

Crops are non-irrigated

Corn = yellow for grain

Soybeans = common soybeans for grain

Wheat = HRS, HRW = Grain

Sunflower = Oil, Non-Oil = Grain

Oats and Barley = Spring for grain

Rye = for grain

Peas = process

Alfalfa, Mixed Forage AGM, GMA, IGS = for forage

Beans = Dry Edible

NAG = for GZ

Canola = Spring for seed

### Common Land Unit

 Non-Cropland

 Cropland

 Tract Boundary

 Roads

### Wetland Determination Identifiers

 Restricted Use

 Limited Restrictions

 Exempt from Conservation

 Compliance Provisions

Tract Cropland Total: 146.00 acres



United States Department of Agriculture (USDA) Farm Service Agency (FSA) maps are for FSA Program administration only. This map does not represent a legal survey or reflect actual ownership; rather it depicts the information provided directly from the producer and/or National Agricultural Imagery Program (NAIP) imagery. The producer accepts the data 'as is' and assumes all risks associated with its use. USDA-FSA assumes no responsibility for actual or consequential damage incurred as a result of any user's reliance on this data outside FSA Programs. Wetland identifiers do not represent the size, shape, or specific determination of the area. Refer to your original determination (CPA-026 and attached maps) for exact boundaries and determinations or contact USDA Natural Resources Conservation Service (NRCS). This map displays the 2021 NAIP imagery.



Revised 5-6-91 SK

SCS-CPA-26  
(07-11-86)U.S. DEPARTMENT OF AGRICULTURE  
Soil Conservation Service

## HIGHLY ERODIBLE LAND AND WETLAND CONSERVATION DETERMINATION

3742

1. NAME OF USDA AGENCY OR PRODUCER REQUESTING DETERMINATION ASCS C/O TRAILL CO. SCS RR 2, BOX C-16 HILLSBORO, N.D. 58045		2. DATE OF REQUEST 10/26/87 Revol. T.V. 12/87	
3. NAME AND ADDRESS OF PRODUCER JAMES R. BRING BOX 51 GALESBURG, N.D. 58035		4. FARM NO. 1309	5. COUNTY NORMAN
6. Is a soil survey now available for making a highly erodible land determination?		YES	NO
7. Are highly erodible soil map units on this farm?		X	
8. a. List highly erodible fields that, according to ASCS records, were used to produce an agricultural commodity in any crop year during 1981-1985. F-1 (E <sub>1/2</sub> SECT 23, STRAND TWP.)			
b. Is an approved conservation plan being actively applied on all of these fields? If "no," list the fields (from the ASCS records) on which a plan is not being applied.			
9. a. List highly erodible fields that, according to ASCS records, have been converted for the production of agricultural commodities, were not used for this purpose in any crop year during 1981-1985, and were not enrolled in a USDA set-aside or diversion program.			
b. Is an approved conservation system being used on these fields? If "no," list the fields (from the ASCS records) on which a system is not being used.			
10. Are there other fields that (1) have highly erodible map units, (2) were not used to produce an agricultural commodity in any crop year after 1980, and (3) were not enrolled in a USDA set-aside or diversion program in any crop year during 1981-1985?			
11. CERTIFICATION. The conservation plan <input type="checkbox"/> and system(s) <input type="checkbox"/> were approved by the _____ Conservation District on _____, 19____, and conform with the technical requirements of the SCS field office technical guide for the _____ District.			
12. Are hydric soils on this farm? If "yes," list the fields (from the ASCS records) in which they occur. HYDRIC COMPONENTS SCATTERED THROUGHOUT FIELD		YES	NO
13. Are wetlands on this farm? If "yes," list the fields, outline the wetland areas within fields on the ASCS photograph(s), and mark with "w". F-1 (E <sub>1/2</sub> SECT 23, STRAND TWP.)		X	
14. Are converted wetlands on this farm that have been converted since December 23, 1985? If "yes," list the fields, outline converted wetlands on the ASCS photograph(s), and mark with "cw".			X
15. Are converted wetlands covered by exemptions? If "yes," list those fields, outline the exempt converted wetlands on the ASCS photograph(s), and mark with "ecw". Note the exemptions for each area:			
a. Field No. _____	c. Field No. _____		
b. Exemption _____	d. Exemption _____		
16. The wetland determination was done in the office <input checked="" type="checkbox"/> field <input type="checkbox"/> .			

17. This determination was hand delivered ☐ mailed ☒ to the producer on 12-17/87  
VIA ASCS/SCS (DATE)

Any producer who does not agree with this determination may request reconsideration from the person making the determination. This request is a prerequisite for any further appeal. The request must be in writing and must set forth reasons for the request. It must be received by SCS within 15 days after the producer receives the determination.

## 18. REMARKS

Determination applies to areas delineated on the accompanying photos. Some ditches may have been in place since 1984. Wetland characteristics still show up.

19. SIGNATURE OF SCS DISTRICT CONSERVATIONIST  
Ronald A. Meff S.C.S. T. VALLEY, MN. DATE 12/17/87

Assistance and programs of the Soil Conservation Service are available without regard to race, religion, color, sex, age, handicap, or national origin.

Strand  
T-374

NORMAN CO. NOT TO SCALE

F-11

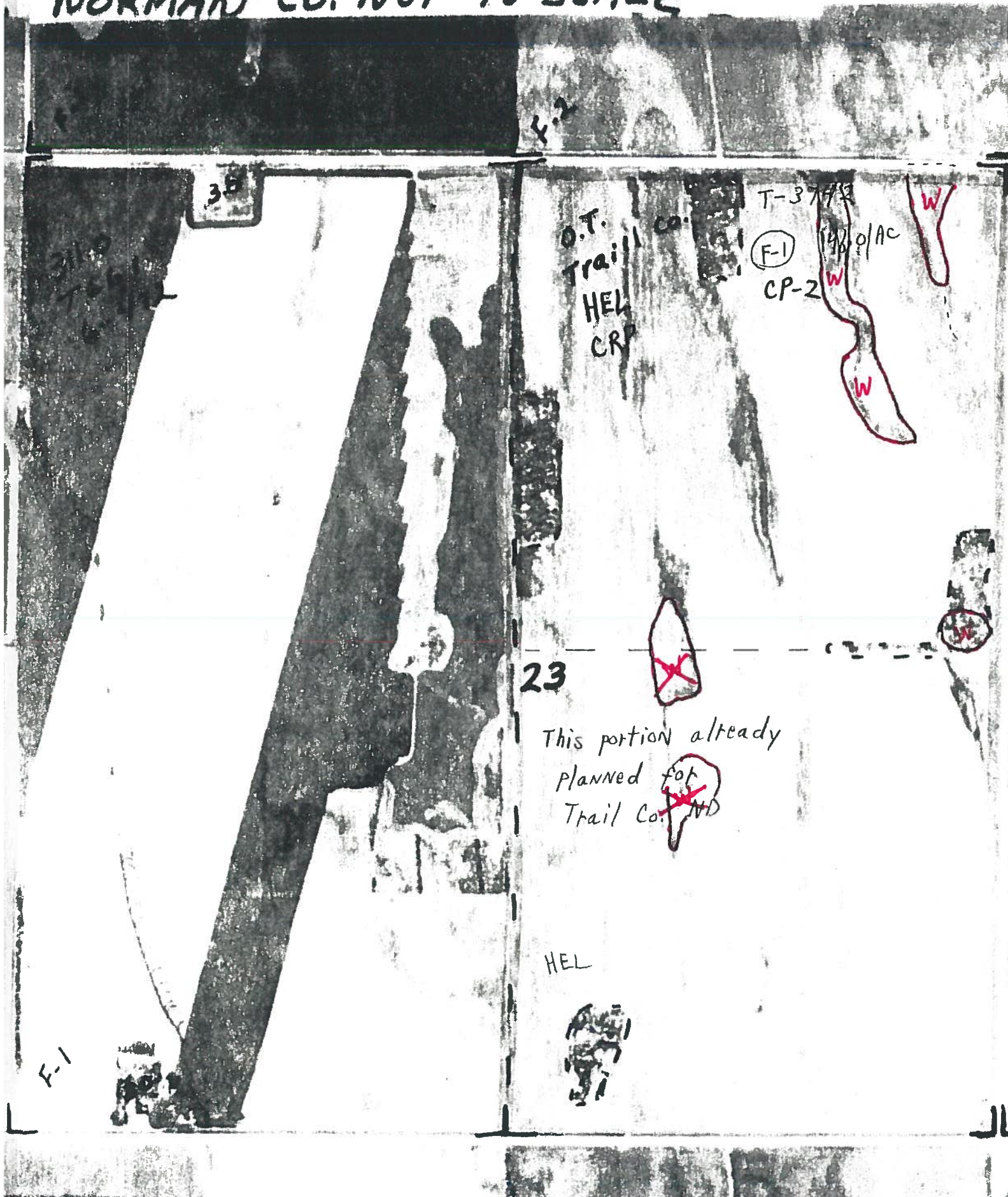

O.T. Trail  
HEL  
CR

T-374  
(F-1)  
CP-2

W

W

23

This portion already  
planned for  
Trail Co. WD

HEL

F-1